

Bryant University

## Bryant Digital Repository

---

Michael E. '67 and Karen L. Fisher Student  
Center

Bryant Named Spaces

---

2020

## Fischer Center Brochure

Office of Campus Engagement

Follow this and additional works at: [https://digitalcommons.bryant.edu/fisher\\_center](https://digitalcommons.bryant.edu/fisher_center)

---



# OUR CAMPUS LIVING ROOM



**FISHER STUDENT CENTER**



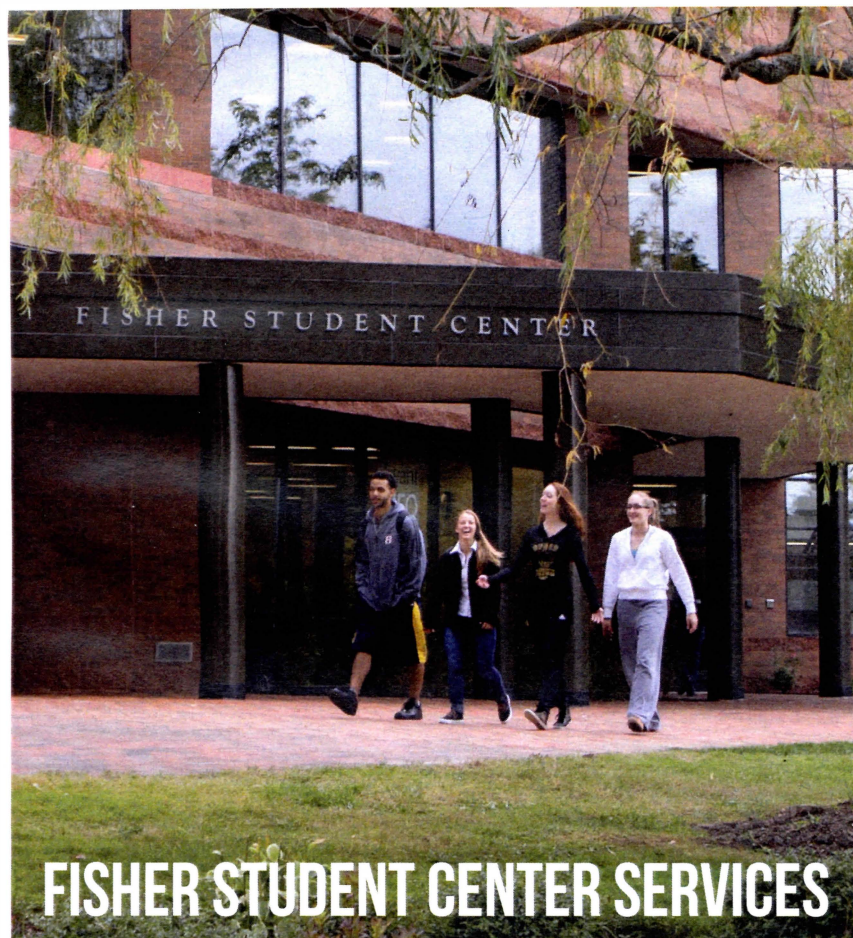

## **FISHER STUDENT CENTER SERVICES**

**Bookstore**  
**Cable Televisions**  
**Center for Diversity & Inclusion**  
**Commuter Hub**  
**Dunkin Donuts**  
**Information Center**  
**Meeting & Event Space**  
**Nick's Place**  
**Office of Campus Engagement**  
**Organization Lockers**

**Printing & Paper Services**  
**Recreational Equipment**  
**Scoop Convenience Store**  
**Social Lounges**  
**Study Areas**  
**Subway**  
**Transportation**  
**University IDs**  
**Wireless Internet**

## Floor 1

1. Meeting Room 1
2. Heritage Meeting Room
3. Papitto Meeting Room
4. Information/Scheduling Center
5. Subway
6. Nick's Place
7. Scoop Convenience Store
8. Dunkin Donuts
9. Music Conference Room
10. Music Practice Room
11. Main Entrances
12. Community Programming Room
13. Fireside Cafe
14. Persuade Lounge

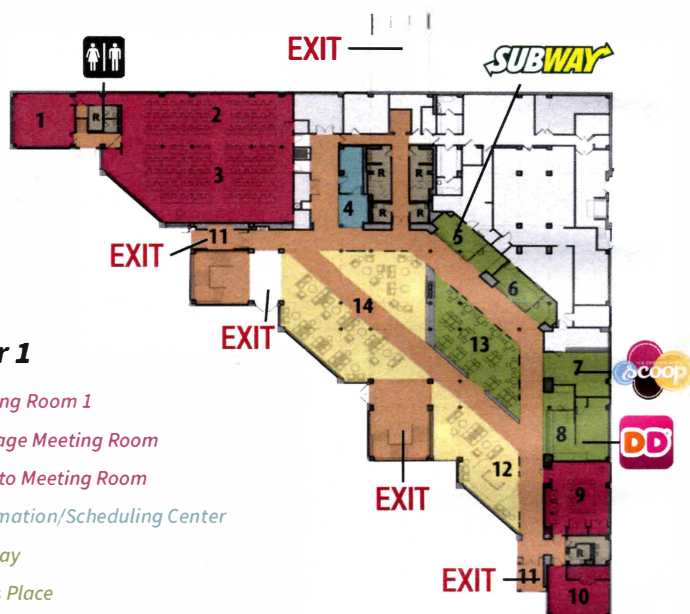

### FALL/SPRING SEMESTER HOURS

MON	7:30am - 1:00am
TUES	7:30am - 1:00am
WED	7:30am - 1:00am
THUR	7:30am - 1:00am
FRI	7:30am - 1:00am
SAT	10:00am - 1:00am
SUN	10:00am - 1:00am

### WINTER/SPRING/SUMMER BREAK HOURS

MON- FRI	8:00am - 5:00pm
SAT	10:00am - 2:00pm

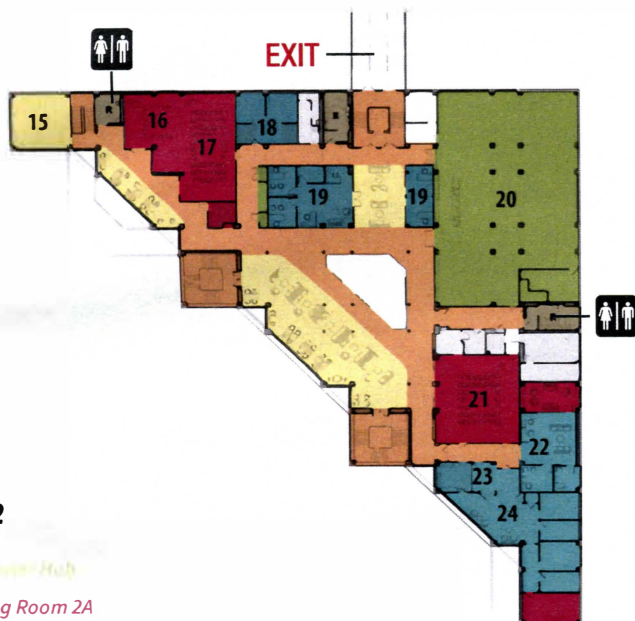

## Floor 2

15. Commons Hub

16. Meeting Room 2A

17. Meeting Room 2B

18. OCE-Involvement

19. OCE-Operations

20. Bryant University Bookstore

21. Meeting Room 2C

22 & 23 & 24. PwC - Center for Diversity & Inclusion  
Hochberg Women's Center / Pride Center / Intercultural Center

## OFFICE OF CAMPUS ENGAGEMENT

### SCHEDULING CENTER (1st Floor)

(401) 232-6117

Monday - Friday

8:30am-4:30pm

### INFORMATION CENTER (1st Floor)

(401) 232-6245

Monday - Friday

8:30am-11:00pm

Saturday 12:00pm-10:00pm

Sunday 12:00pm-11:00pm



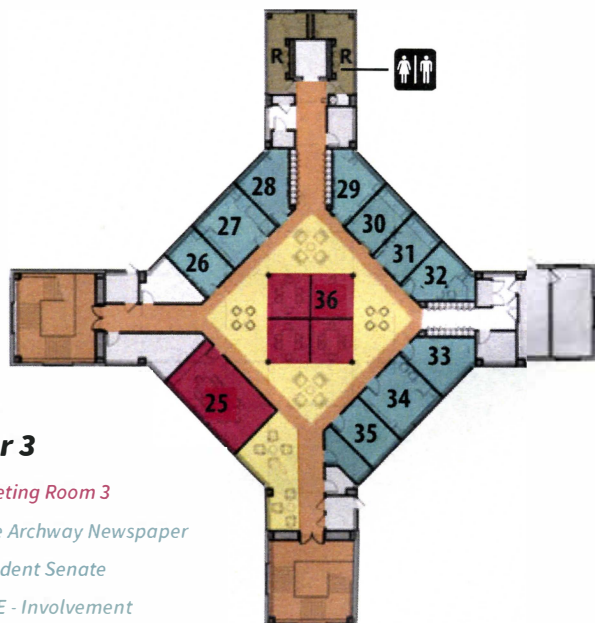

### Floor 3

- 25. Meeting Room 3
- 26. The Archway Newspaper
- 27. Student Senate
- 28. OCE - Involvement
- 29. Greek Life
- 30. OCE - Involvement
- 31. OCE-Resource Center
- 32. Multicultural Student Union
- 33. ISO
- 34. Student Programming Board
- 35. Ledger Yearbook
- 36. Leadership Pods

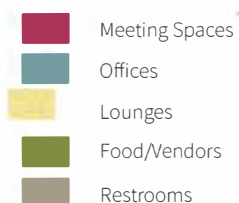

#### INVOLVEMENT (2nd Floor)

(401) 232-6160  
Monday - Friday  
8:30am-4:30pm

#### OPERATIONS (2nd Floor)

(401) 232-6993  
Monday - Friday  
8:30am-4:30pm

#### ORGANIZATION RESOURCE CENTER (3rd Floor)

(401) 232-6954  
Monday - Thursday  
10:00am-7:30pm  
Friday 10:00am-4:30pm

## MISSION STATEMENT

The Office of Campus Engagement strives to create an inclusive atmosphere that fosters personal and professional growth through leadership, programming, service opportunities, and new student programs. Built on the foundation of the Fisher Student Center, the living room of the campus, we provide services and programs which enhance the life of our community. Our team supports, challenges, and mentors students, employees and organizations to fulfill the mission and vision of Bryant University.

## FISHER ADVISORY BOARD

The Fisher Advisory Board (FAB) enhances the environment of Our Campus Living Room through partnerships, services and best student union practices. FAB shall execute this under the authority of the power granted to this organization through student representation on FAB and the appointment of professional staff and vendors, in addition to support from the University Community. FAB is responsible for providing a diverse range of programming that will encourage student engagement and sense of belonging, in addition to evaluating building operations and making recommendations on policy, coordination of meetings and events, and the student employee program.

#BryantOCE

